

FCC WARNING

This device complies with part 15 of the FCC Rules. Operation is subject to the following two conditions:
(1) This device may not cause harmful interference, and (2) this device must accept any interference received, including interference that may cause undesired operation. Any changes or modifications not expressly approved by the party responsible for compliance could void the user's authority to operate the equipment.
Note: This equipment has been tested and found to comply with the limits for a Class B digital device, pursuant to part 15 of the FCC Rules. These limits are designed to provide reasonable protection against harmful interference in a residential installation. This equipment generates uses and can radiate radio frequency energy and, if not installed and used in accordance with the instructions, may cause harmful interference to radio communications. However, there is no guarantee that interference will not occur in a particular installation.

If this equipment does cause harmful interference to radio or television reception, which can be determined by turning the equipment off and on, the user is encouraged to try to correct the interference by one or more of the following measures:
● Reorient or relocate the receiving antenna.
● Increase the separation between the equipment and receiver.
● Connect the equipment into an outlet on a circuit different from that to which the receiver is connected.
● Consult the dealer or an experienced radio/TV technician for help.
The device has been evaluated to meet general RF exposure requirement. The device can be used in portable exposure condition without restriction.



GUARANTEE
Non-human damage
12-month warranty

BASIC INFORMATION



Manual

● Size: 391.7(L)×151.5(W)×41.7(H)±2



Switch Puller

● Backlight: RGB



Keyboard

● Connection: USB/2.4G/BT

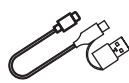

Type-C Cable

● Layout: 94keys



Receiver

● Switch: Mechanical switch

TOGGLE SWITCH FUNCTION

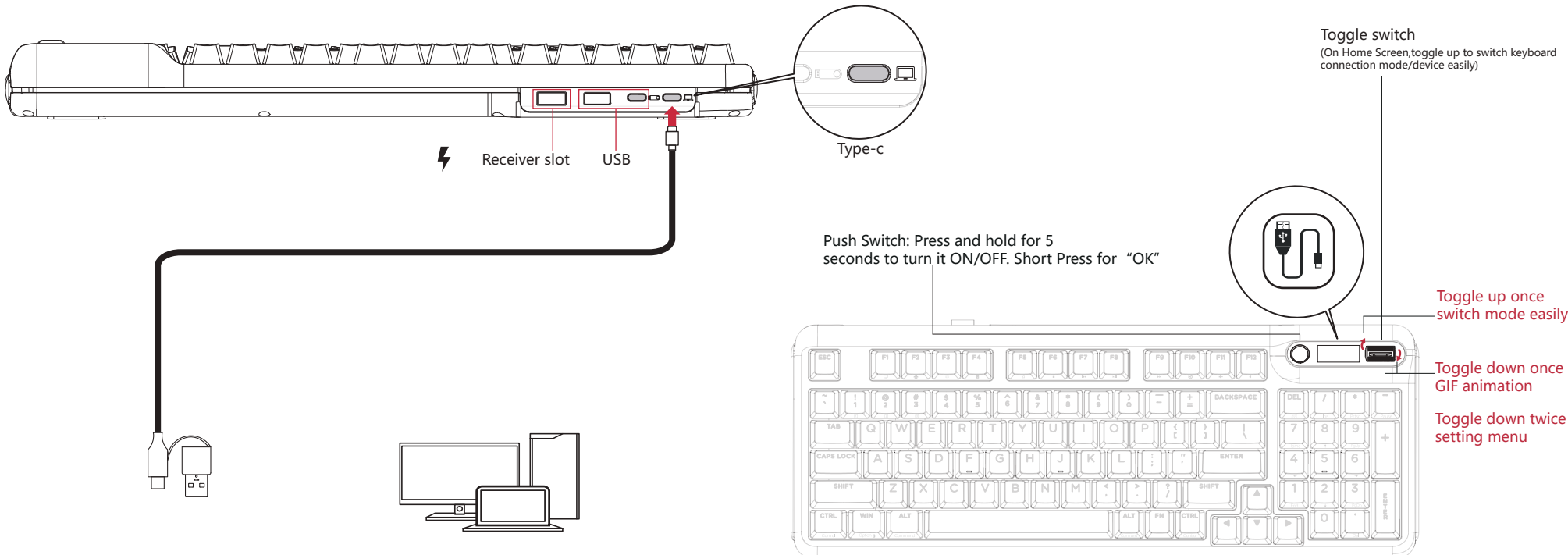

BLUETOOTH CONNECTIVITY

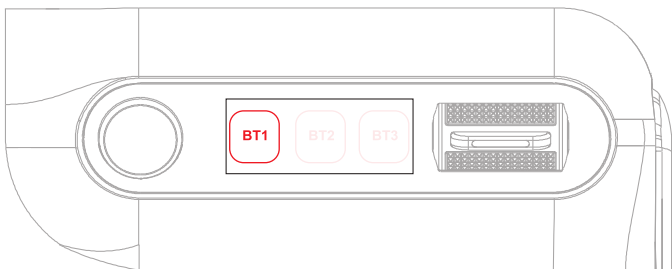

1. Use the toggle to select **BT1/BT2/BT3** icon, and connect any group of Bluetooth. **Pairing setting:** for example, select **BT1**, then press and hold **"OK"** until it shows **BT1** is pairing, which means that the pairing is in progress. **Re-connection setting:** for example, select **BT1**, then click **'OK'**, and it shows **BT1** is linking, which means that you have entered the reconnect state.
2. Turn on the bluetooth settings of your device, then search and connect **"KZZI Z98"**
3. Once it's done, the display shows **"BT1 success!"** and back to the Home Screen. Similarly, follow the steps above to store 3 groups of different **BT** devices.

(Kind Reminder: please store 3 groups of BT device before switching.)

2.4G CONNECTIVITY

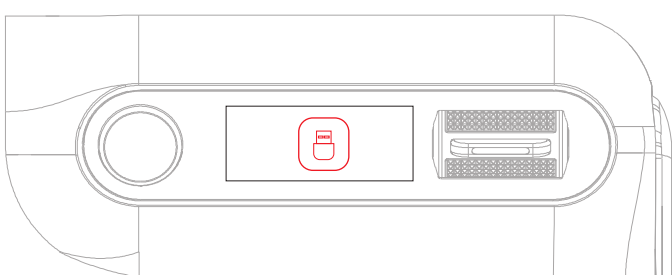

2.4G mode: use the toggle to select the 2.4G icon, and click the Push Switch. Keyboard switches to 2.4G mode and the display shows "2.4G linking".

2.4G pairing: use the toggle switch to select the 2.4G icon, and press and hold the Push Switch until the display shows "2.4G pairing"; then insert receiver, and the display shows "2.4G success".

(Kind Reminder: The receiver has been paired before delivery, no need to pair 2.4G again; This method is only used when 2.4G cannot be connected, you can set it for the first time, no need to set it every time)

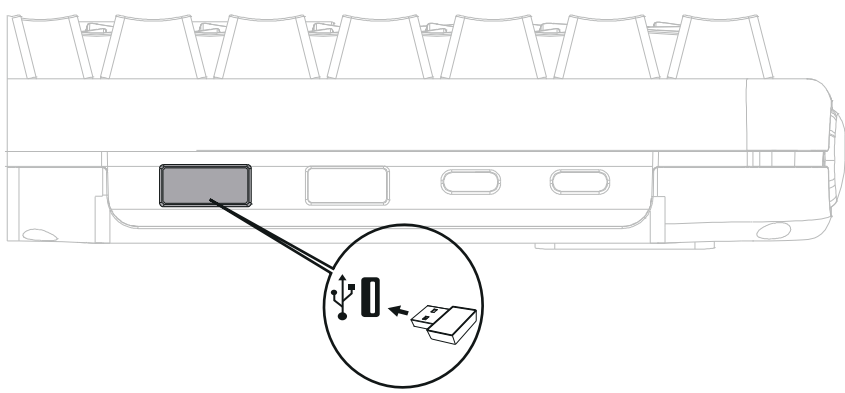

Receiver storage compartment

FUNCTION KEYS, TOGGLE SWITCH, DISPLAY OPERATION

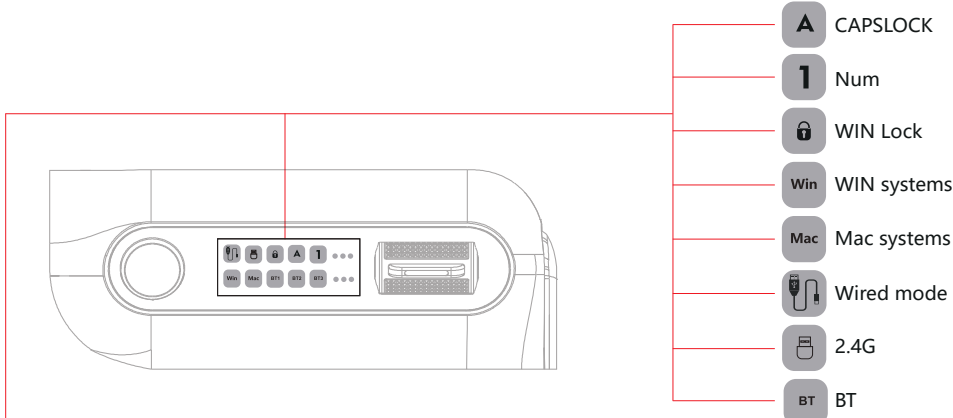

Pressing **FN+Win** locks the **WIN** key and **APP** key functions. Press and hold **FN+ spacebar** for 3 seconds to restore factory settings.

GIF animation displayed on screen when powering on

Layout switching: Win/Mac
Volume adjustment
Language selection: English/Chinese

Backlight Effect/Colour Settings

1. Select the effect icon and press **"OK"**.

Use the toggle switch to choose different backlight effects.

2. Select the colour icon and press **"OK"**.

Use the toggle switch to choose different backlight colour. (This also supports color selection for backlit recording)

Backlight brightness/speed setting

1. Select the Brightness icon and press **"OK"**.

Use the toggle switch to adjust backlight brightness.

2. Select the Speed icon and press **"OK"**.

Use the toggle switch to adjust backlight effect speed.

RESET KEYBOARD WITH SIDE WING

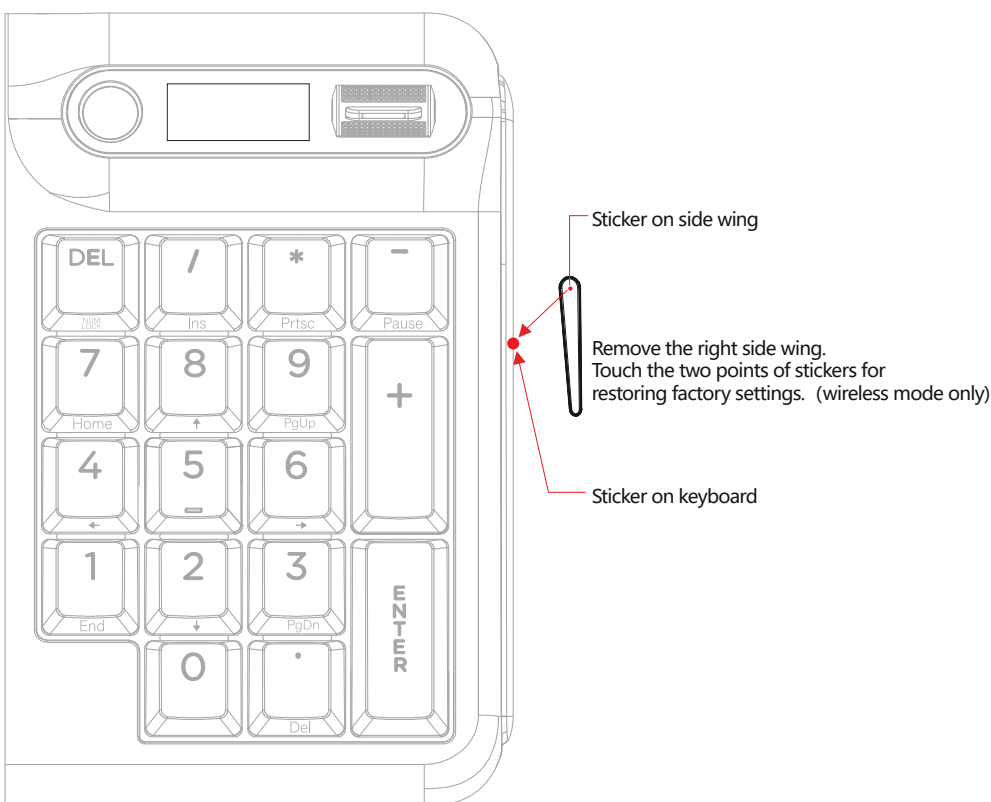

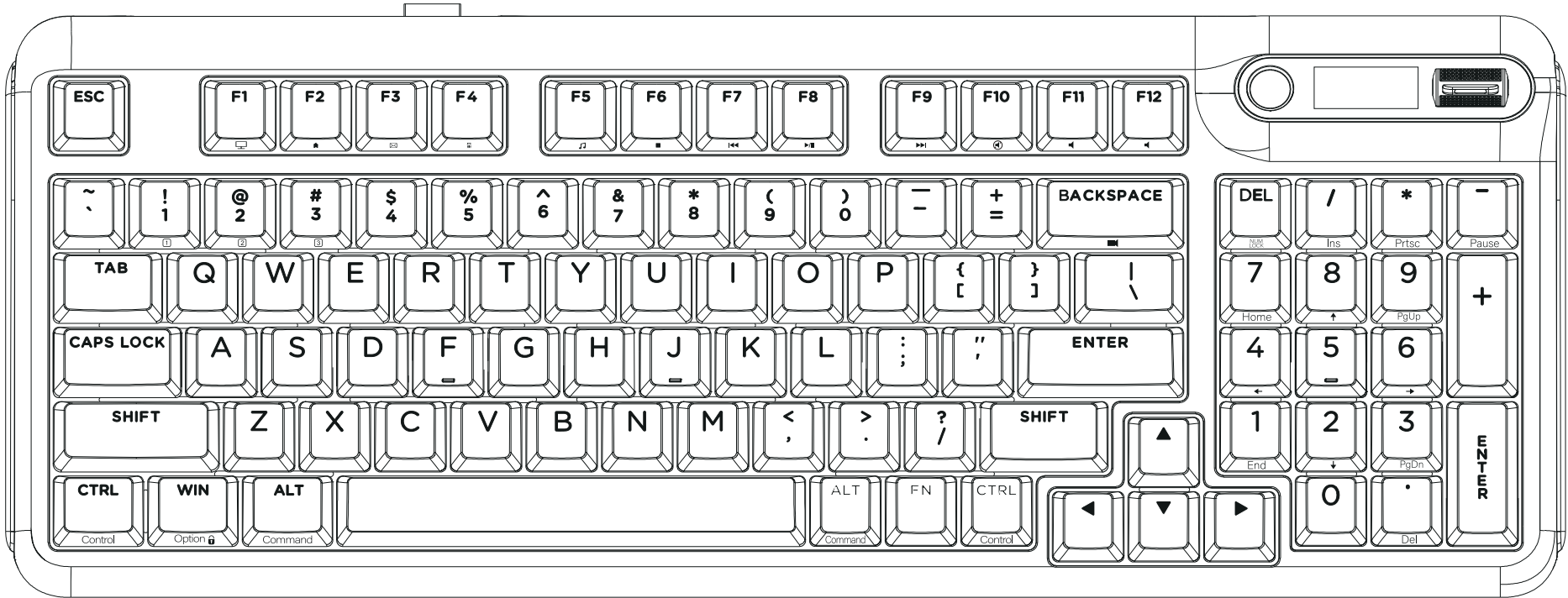

FCC WARNING

This device complies with part 15 of the FCC Rules. Operation is subject to the following two conditions:
(1) This device may not cause harmful interference, and (2) this device must accept any interference received, including interference that may cause undesired operation. Any changes or modifications not expressly approved by the party responsible for compliance could void the user's authority to operate the equipment.
Note: This equipment has been tested and found to comply with the limits for a Class B digital device, pursuant to part 15 of the FCC Rules. These limits are designed to provide reasonable protection against harmful interference in a residential installation. This equipment generates uses and can radiate radio frequency energy and, if not installed and used in accordance with the instructions, may cause harmful interference to radio communications. However, there is no guarantee that interference will not occur in a particular installation.

If this equipment does cause harmful interference to radio or television reception, which can be determined by turning the equipment off and on, the user is encouraged to try to correct the interference by one or more of the following measures:
●Reorient or relocate the receiving antenna.
●Increase the separation between the equipment and receiver.
●Connect the equipment into an outlet on a circuit different from that to which the receiver is connected.
●Consult the dealer or an experienced radio/TV technician for help.
The device has been evaluated to meet general RF exposure requirement. The device can be used in portable exposure condition without restriction.



GUARANTEE
Non-human damage
12-month warranty

BACKLIGHT RECORDING METHOD

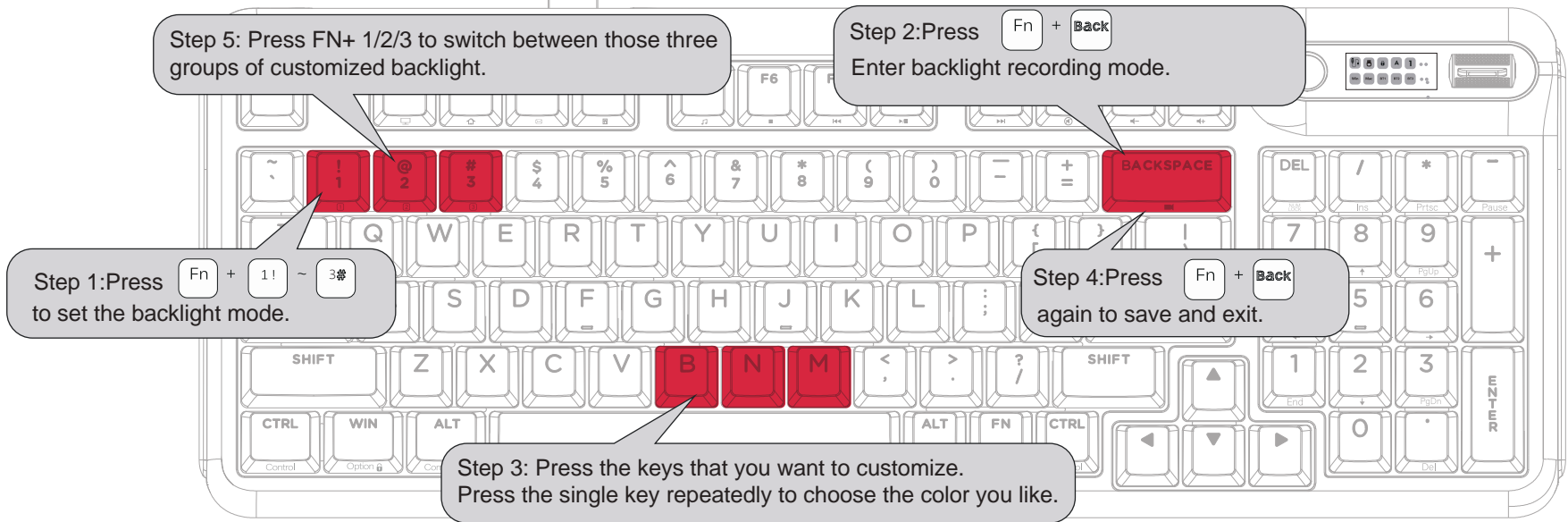

WINDOWS MULTIMEDIA KEYS

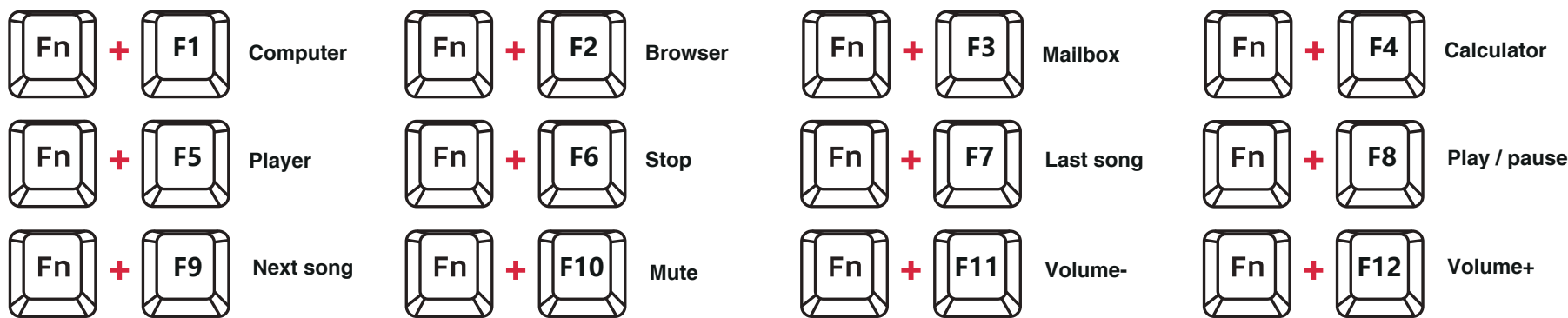

MAC MULTIMEDIA KEYS

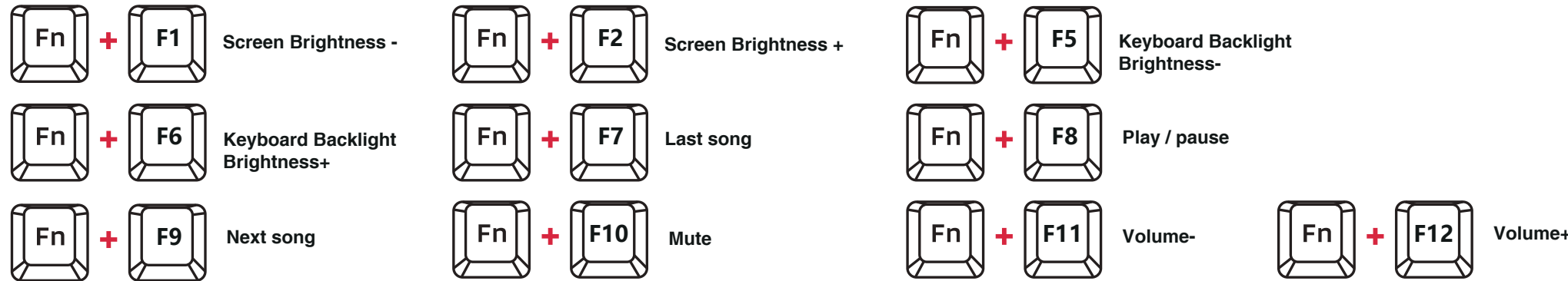

SPECIAL FUNCTION KEYS

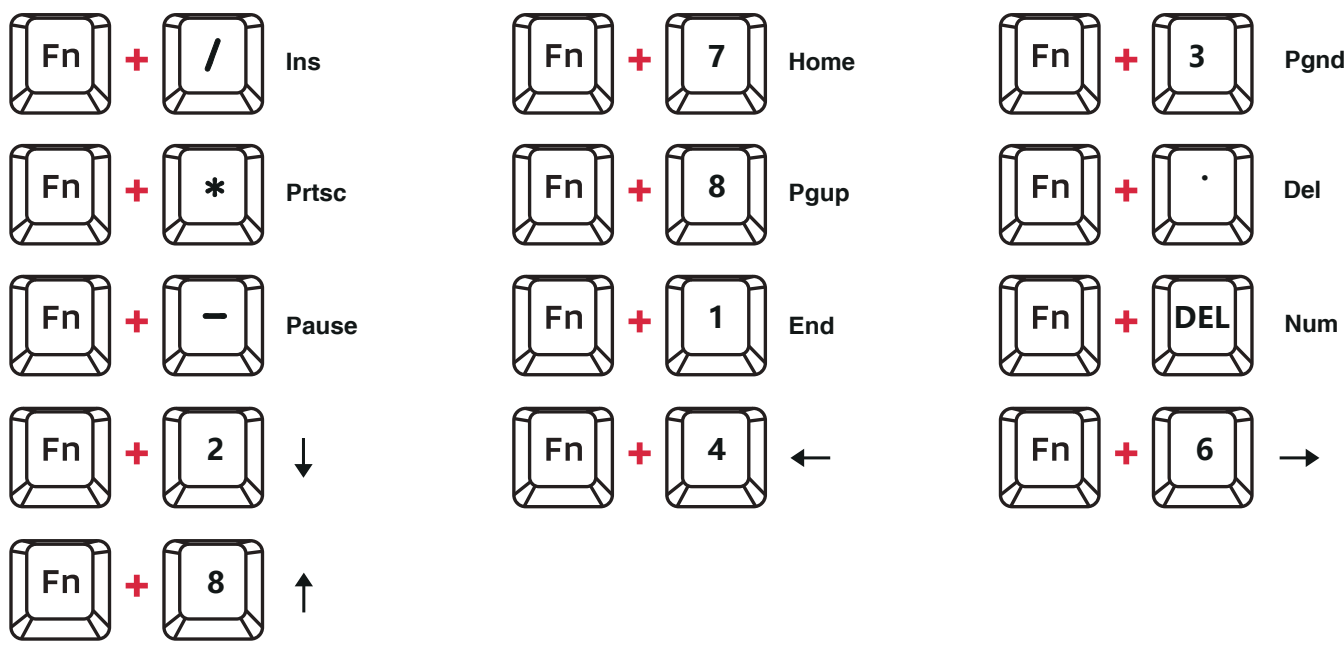

SYSTEM REQUIREMENTS

- BT Mode**
- Device With Bluetooth 5.1 or later
 - PC: Windows 7 or Later
 - Mac: macOS X 10.6 Snow Leopard or Later
 - iOS: All iPads/iPhone 5 or Later
 - Android: 5.0 Lollipop or Later
- Wired/2.4Ghz Mode**
- Computer With Available USB port
 - PC: Windows 7 or Later
 - Mac: macOS X 10.6 Snow Leopard or Later

Is there a problem with our kzzi products?

Please contact us and we will respond as soon as possible to ensure that all your needs are addressed

KZZI